

Welding Flange ISO-K

Flange: ISO-K, according to DIN 28404



| Artikelnummer | Material | DN | A | B | C |
|---------------|--------------------------|--------|-------|-------|------|
| 063KL/A | Steel | DN 63 | 95.0 | 76.5 | 12.0 |
| 063KL/B | Stainless Steel (1.4301) | DN 63 | 95.0 | 76.5 | 12.0 |
| 063KL/B4404 | Stainless Steel (1.4404) | DN 63 | 95.0 | 76.5 | 12.0 |
| 063KL/B4571 | Stainless Steel (1.4571) | DN 63 | 95.0 | 76.5 | 12.0 |
| 100KL/A | Steel | DN 100 | 130.0 | 108.6 | 12.0 |
| 100KL/B | Stainless Steel (1.4301) | DN 100 | 130.0 | 108.6 | 12.0 |
| 100KL/B4404 | Stainless Steel (1.4404) | DN 100 | 130.0 | 108.6 | 12.0 |
| 100KL/B4571 | Stainless Steel (1.4571) | DN 100 | 130.0 | 108.6 | 12.0 |
| 160KL/A | Steel | DN 160 | 180.0 | 160.2 | 12.0 |
| 160KL/B | Stainless Steel (1.4301) | DN 160 | 180.0 | 160.2 | 12.0 |
| 160KL/B4404 | Stainless Steel (1.4404) | DN 160 | 180.0 | 160.2 | 12.0 |
| 160KL/B4571 | Stainless Steel (1.4571) | DN 160 | 180.0 | 160.2 | 12.0 |
| 200KL/A | Steel | DN 200 | 240.0 | 220.0 | 12.0 |
| 200KL/B | Stainless Steel (1.4301) | DN 200 | 240.0 | 220.0 | 12.0 |
| 200KL/B4404 | Stainless Steel (1.4404) | DN 200 | 240.0 | 220.0 | 12.0 |
| 200KL/B4571 | Stainless Steel (1.4571) | DN 200 | 240.0 | 220.0 | 12.0 |
| 250KL/A | Steel | DN 250 | 290.0 | 274.0 | 12.0 |
| 250KL/B | Stainless Steel (1.4301) | DN 250 | 290.0 | 274.0 | 12.0 |
| 250KL/B4404 | Stainless Steel (1.4404) | DN 250 | 290.0 | 274.0 | 12.0 |

Datasheet

| | | | | | |
|-------------|--------------------------|--------|-------|-------|------|
| 250KL/B4571 | Stainless Steel (1.4571) | DN 250 | 290.0 | 274.0 | 12.0 |
| 320KL/A | Steel | DN 320 | 370.0 | 324.0 | 17.0 |
| 320KL/B | Stainless Steel (1.4301) | DN 320 | 370.0 | 324.0 | 17.0 |
| 320KL/B4404 | Stainless Steel (1.4404) | DN 320 | 370.0 | 324.0 | 17.0 |
| 400KL/A | Steel | DN 400 | 450.0 | 407.0 | 17.0 |
| 400KL/B | Stainless Steel (1.4301) | DN 400 | 450.0 | 407.0 | 17.0 |
| 500KL/A | Steel | DN 500 | 550.0 | 509.0 | 17.0 |
| 500KL/B | Stainless Steel (1.4301) | DN 500 | 550.0 | 509.0 | 17.0 |
| 500KL/B4404 | Stainless Steel (1.4404) | DN 500 | 550.0 | 509.0 | 17.0 |

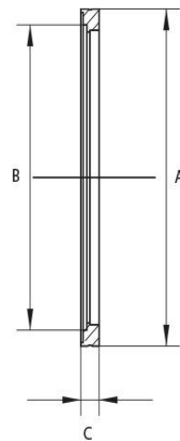

this product is compliant with both REACH and RoHS regulations