

Welding Flange ISO-CF rotatable

Flange: ISO-CF, according to ISO 3669
 Leak rate: 1×10^{-12} mbar · l/s
 Bakeout temperature: up to 400°C



Artikelnummer	Material	DN	A	B
016CFR/B	Stainless Steel (1.4301)	DN 16	7.5	18.0
040CFR/B	Stainless Steel (1.4301)	DN 40	13.0	40.0
063CFR/B	Stainless Steel (1.4301)	DN 63	17.5	70.0
100CFR/B	Stainless Steel (1.4301)	DN 100	20.0	108.0
160CFR/B	Stainless Steel (1.4301)	DN 160	22.0	159.0
200CFR/B	Stainless Steel (1.4301)	DN 200	24.5	205.0
250CFR/B	Stainless Steel (1.4301)	DN 250	24.5	256.0

CF-F = non-rotatable flange CF-R = rotatable flange

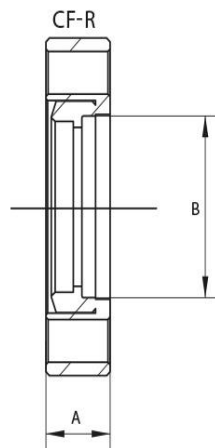

this product is compliant with both REACH and RoHS regulations