

Tee ISO-CF

Flange: ISO-CF, according to ISO 3669



Artikelnummer	Material	DN	A	B
016TS/CF	Stainless Steel (1.4301)	DN 16	38.0	76.0
040TS/CF	Stainless Steel (1.4301)	DN 40	63.0	126.0
063TS/CF	Stainless Steel (1.4301)	DN 63	105.0	210.0
100TS/CF	Stainless Steel (1.4301)	DN 100	135.0	270.0
160TS/CF	Stainless Steel (1.4301)	DN 160	167.0	334.0

CF-F = non-rotatable flange CF-R = rotatable flange

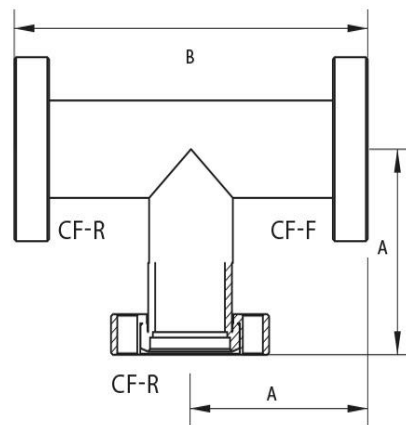

this product is compliant with both REACH and RoHS regulations