

Outer Centering Ring with Inner Ring

Flange: ISO-KF, according to DIN 28403

Leak rate: 1×10^{-9} mbar · l/s



Artikelnummer	Material	DN	A	B	C
016ZA/BNC	Stainless Steel / NBR / Aluminum	DN 16	16.0	32.5	8
016ZA/BVB	Stainless Steel / FPM / Stainless Steel	DN 16	16.0	32.5	8
016ZA/BVC	Stainless Steel / FPM / Aluminum	DN 16	16.0	32.5	8
016ZA/BVC4404	Stainless Steel (1.4404) / FPM / Aluminum	DN 16	16.0	32.5	8
025ZA/BNC	Stainless Steel / NBR / Aluminum	DN 25	25.0	42.5	8
025ZA/BVB	Stainless Steel / FPM / Stainless Steel	DN 25	25.0	42.5	8
025ZA/BVC	Stainless Steel / FPM / Aluminum	DN 25	25.0	42.5	8
025ZA/BVC4404	Stainless Steel (1.4404) / FPM / Aluminum	DN 25	25.0	42.5	8
040ZA/BNC	Stainless Steel / NBR / Aluminum	DN 40	40.0	57.5	8
040ZA/BVB	Stainless Steel / FPM / Stainless Steel	DN 40	40.0	57.5	8
040ZA/BVC	Stainless Steel / FPM / Aluminum	DN 40	40.0	57.5	8
040ZA/BVC4404	Stainless Steel (1.4404) / FPM / Aluminum	DN 40	40.0	57.5	8
050ZA/BNC	Stainless Steel / NBR / Aluminum	DN 50	50.0	77.5	8

Datasheet

050ZA/BVB	Stainless Steel / FPM / Stainless Steel	DN 50	50.0	77.5	8
050ZA/BVC	Stainless Steel / FPM / Aluminum	DN 50	50.0	77.5	8
050ZA/BVC4404	Stainless Steel (1.4404) / FPM / Aluminum	DN 50	50.0	77.5	8

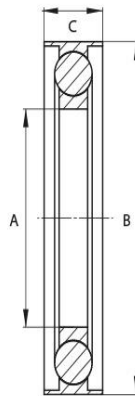

this product is compliant with both REACH and RoHS regulations