

Datasheet

Metal Hose ISO-K

Flange: ISO-K, according to DIN 28404

Leak rate: 1×10^{-9} mbar · l/s

Max pressure: max. 1.5 bar

Material: - Flange | 1.4301

- Bellow | 1.4404

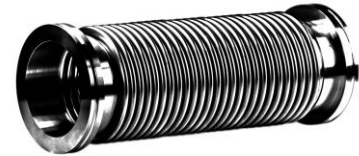

Artikelnummer	Material	DN	A	B	C
063WS1000B	Stainless Steel (1.4301)	DN 63	1000.0	250.0	160
063WS1500B	Stainless Steel (1.4301)	DN 63	1500.0	250.0	160
063WS250B	Stainless Steel (1.4301)	DN 63	250.0	250.0	160
063WS500B	Stainless Steel (1.4301)	DN 63	500.0	250.0	160
063WS750B	Stainless Steel (1.4301)	DN 63	750.0	250.0	160
100WS1000B	Stainless Steel (1.4301)	DN 100	1000.0	370.0	240
100WS250B	Stainless Steel (1.4301)	DN 100	250.0	370.0	240
100WS500B	Stainless Steel (1.4301)	DN 100	500.0	370.0	240
100WS750B	Stainless Steel (1.4301)	DN 100	750.0	370.0	240
160WS1000B	Stainless Steel (1.4301)	DN 160	1000.0	720.0	350
160WS250B	Stainless Steel (1.4301)	DN 160	250.0	720.0	350
160WS500B	Stainless Steel (1.4301)	DN 160	500.0	720.0	350

B= radius multiple bending | C= radius single bending

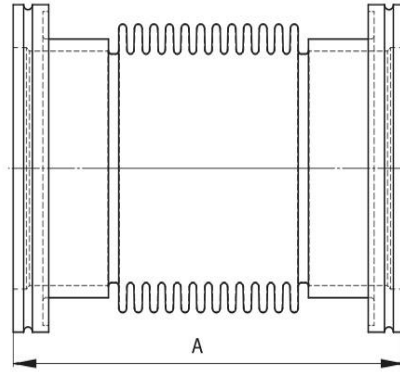

this product is compliant with both REACH and RoHS regulations