

Datasheet

Cross ISO-KF

Flange: ISO-KF, according to DIN 28403
 Leak rate: 1×10^{-9} mbar · l/s
 Surface: glass-bead blasted



Artikelnummer	Material	DN	A	B
010KS/B	Stainless Steel (1.4301)	DN 10	30.0	60.0
010KS/C	Aluminum	DN 10	30.0	60.0
016KS/B	Stainless Steel (1.4301)	DN 16	40.0	80.0
016KS/C	Aluminum	DN 16	40.0	80.0
025KS/B	Stainless Steel (1.4301)	DN 25	50.0	100.0
025KS/C	Aluminum	DN 25	50.0	100.0
040KS/B	Stainless Steel (1.4301)	DN 40	65.0	130.0
040KS/C	Aluminum	DN 40	65.0	130.0
050KS/B	Stainless Steel (1.4301)	DN 50	70.0	140.0

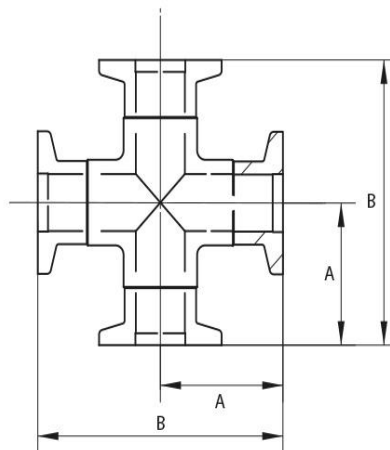

this product is compliant with both REACH and RoHS regulations