

# Centering Ring with Outer Ring

Flange: ISO-K, according to DIN 28404

Leak rate:  $1 \times 10^{-9}$  mbar · l/s



Artikelnummer	Material	DN	A	B	C	D
063ZA/BVC	Stainless Steel / FPM / Aluminum	DN 63	96.0	70.0	3.9	8
063ZA/CNC	Aluminum / NBR / Aluminum	DN 63	96.0	70.0	3.9	8
063ZA/CVC	Aluminum / FPM / Aluminum	DN 63	96.0	70.0	3.9	8
1000ZA/CVC	Aluminum / FPM / Aluminum	DN 1000	1040.0	1000.0	5.6	14
100ZA/BVC	Stainless Steel / FPM / Aluminum	DN 100	128.0	102.0	3.9	8
100ZA/CNC	Aluminum / NBR / Aluminum	DN 100	128.0	102.0	3.9	8
100ZA/CVC	Aluminum / FPM / Aluminum	DN 100	128.0	102.0	3.9	8
160ZA/BVC	Stainless Steel / FPM / Aluminum	DN 160	179.0	150.0	3.9	8
160ZA/CNC	Aluminum / NBR / Aluminum	DN 160	179.0	153.0	3.9	8
160ZA/CVC	Aluminum / FPM / Aluminum	DN 160	179.0	153.0	3.9	8
200ZA/BVC	Stainless Steel / FPM / Aluminum	DN 200	239.0	209.0	3.9	8
200ZA/CNC	Aluminum / NBR / Aluminum	DN 200	239.0	213.0	3.9	8

# Datasheet

200ZA/CVC	Aluminum / FPM / Aluminum	DN 200	239.0	213.0	3.9	8
250ZA/BVC	Stainless Steel / FPM / Aluminum	DN 250	287.0	261.0	3.9	8
250ZA/CNC	Aluminum / NBR / Aluminum	DN 250	287.0	261.0	3.9	8
250ZA/CVC	Aluminum / FPM / Aluminum	DN 250	287.0	261.0	3.9	8
320ZA/BVC	Stainless Steel / FPM / Aluminum	DN 320	358.0	318.0	5.6	14
320ZA/CNC	Aluminum / NBR / Aluminum	DN 320	358.0	318.0	5.6	14
320ZA/CVC	Aluminum / FPM / Aluminum	DN 320	358.0	318.0	5.6	14
400ZA/CNC	Aluminum / NBR / Aluminum	DN 400	440.0	400.0	5.6	14
400ZA/CVC	Aluminum / FPM / Aluminum	DN 400	440.0	400.0	5.6	14
500ZA/CNC	Aluminum / NBR / Aluminum	DN 500	541.0	501.0	5.6	14
500ZA/CVC	Aluminum / FPM / Aluminum	DN 500	541.0	501.0	5.6	14
630ZA/CNC	Aluminum / NBR / Aluminum	DN 630	691.0	651.0	5.6	14
630ZA/CVC	Aluminum / FPM / Aluminum	DN 630	691.0	651.0	5.6	14
800ZA/CVC	Aluminum / FPM / Aluminum	DN 800	840.0	800.0	5.6	14

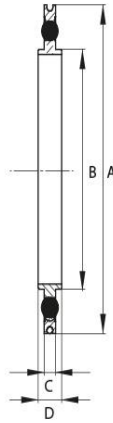

this product is compliant with both REACH and RoHS regulations